

Lighting

Linear luminaire For fluorescent lamps

GRP

6401/562-8508-25-232 Art. No. 239563



- Can be used in Ex Zones 2, 21 and 22
- Explosion-protected linear luminaire with two fluorescent lamps: 18 W, 36 W and 58 W
- Extremely robust: Impact strength rating of IK10

WebCode 6401A



The 6401 EXLUX luminaire is suited to normal indoor and outdoor lighting applications. In no time at all and with very little effort, using the accessories it can be fitted to the wall, ceiling or a pole, or alternatively, it can be suspended. The practical central lock is available with an optional switching element that disconnects the power supply at all poles when the plastic enclosure is opened. Lightweight yet strong: The high-quality workmanship makes this luminaire robust and minimises maintenance requirements.

Technical Data

Explosion Protection

Application range (zones)	2 21 22
IECEX gas certificate	IECEX PTB 14.0035
ATEX gas certificate	PTB 14 ATEX 2017
IECEX dust certificate	IECEX PTB 14.0035
ATEX dust certificate	PTB 14 ATEX 2016
Ambient temperature °C	-20 ... +50 °C
Note: Through wiring	Max. 3x16 A
Gas explosion protection IECEX	Ex ec IIC T4 Gc
Gas explosion protection ATEX	Ex II 3 G Ex ec IIC T4 Gc
Dust explosion protection IECEX	Ex tb IIIC T80 °C Db
Dust explosion protection ATEX	Ex II 2 D Ex tb IIIC T80 °C Db
Dust explosion protection IECEX 2	Ex tc IIIC TT80 °C Db
Dust Explosion Protection ATEX 2	Ex II 2 D Ex tc IIIC TT80 °C Db
Certificates	ATEX (PTB), IECEX (PTB)
Languages of the documentation	German English

Electrical Data

Ex version	Yes
Rated operational voltage AC	220 – 240 V
Rated operational voltage DC	220 – 240 V
Frequency range	50 – 60 Hz
Lamp wattage	58 W

Lighting

Linear luminaire For fluorescent lamps

GRP

6401/562-8508-25-232 Art. No. 239563



Lighting Data

Number of lamps	2
Lamp wattage	58 W
Lamp	G13 lamp base
Luminaire efficacy	0 lm/W
Luminous flux	0 lm
Colour temperature	0 K

Ambient Conditions

Ambient temperature	-20 °C ... +50 °C (Max. 3x16 A)
---------------------	---------------------------------

Mechanical Data

Version	Standard
Degree of protection IP (IEC 60598)	IP66
Protection class	I (with inner PE connection)
Enclosure material	Polyester resin, Glass fibre reinforced
Sealing material	Silicone
Material translucent cover	Polycarbonate
Installed terminal strip	PE + N + L1 + L2 + L3
Connection terminals solid max.	6 mm ²
Connection terminals finely-stranded max.	4 mm ²
Type of connection cable	Solid Finely stranded Extra-finely stranded
Design size	6
Width	184 mm
Height	125 mm
Length	1610 mm
Impact strength (IK code)	IK10 (IEC 62262)
Enclosure colour	Light grey (RAL 7035)
Weight	7.9 kg
Disconnection of the luminaire	No

Components

Threaded plate	2x SS430 stainless steel
Ballast	ELXe
Through wiring	With 5 conductors 2.5 mm ²
Drilled holes	3 x M20
Screw connections	Can be ordered as accessories
Stopping plug	Can be ordered as accessories
Accessories	Installed

Lighting

Linear luminaire For fluorescent lamps

GRP

6401/562-8508-25-232 Art. No. 239563



Light Distribution Curves

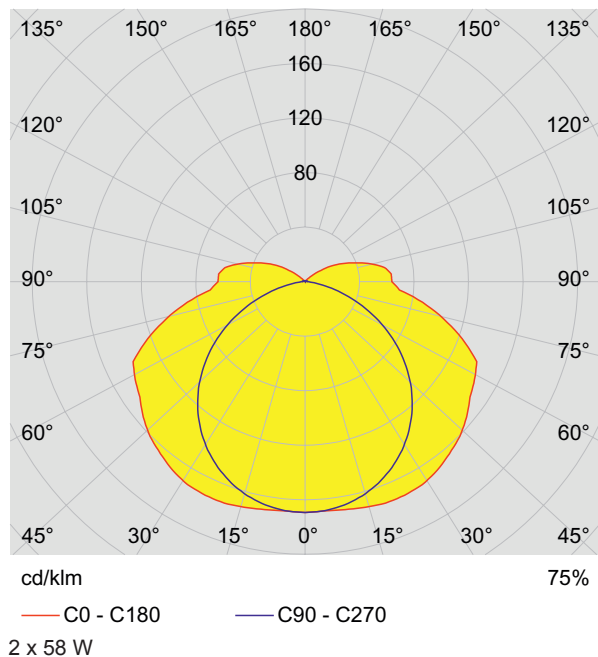

Dimensional Drawings (All Dimensions in mm [inches]) – Subject to Alterations

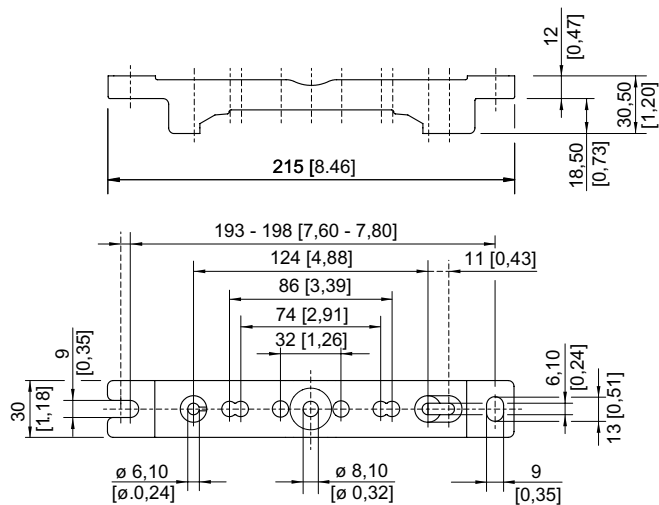

Mounting rail

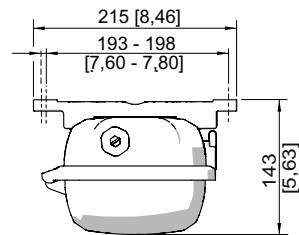

Mounting rail

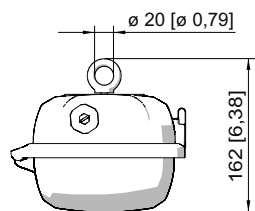

Ring bolt fitted in insert nut of the luminaire

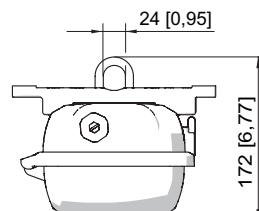

Mounting bracket fitted in mounting rail

Lighting

Linear luminaire For fluorescent lamps

GRP

6401/562-8508-25-232 Art. No. 239563

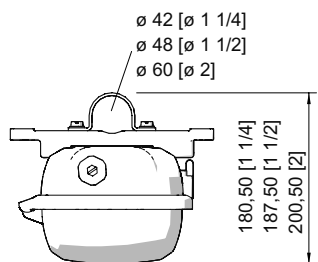

Pipe clamp fitted in mounting rail

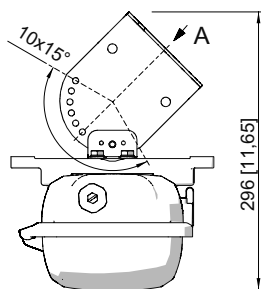

A

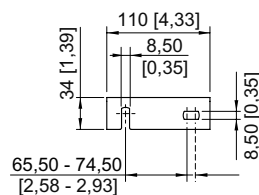

Wall mounting bracket fitted in mounting rail

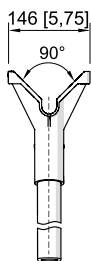
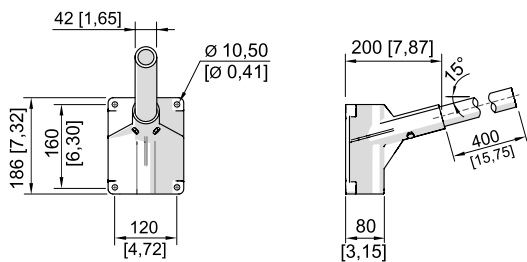

Bracket for wall mounting with pipe section

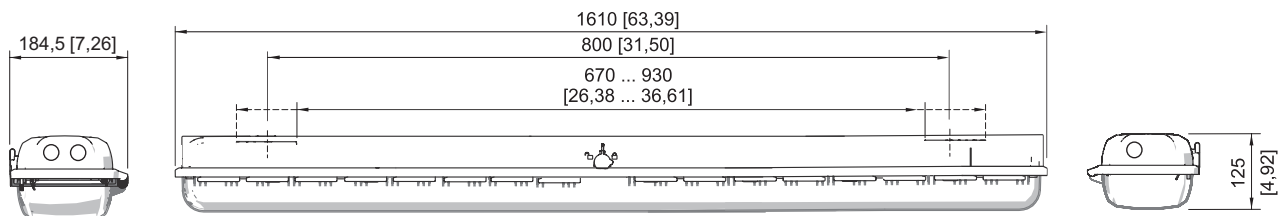

Size 6

Accessories and Spare Parts

		Art. No.
	G13 lamp holder for light fittings with T8 fluorescent lamps for use in Zone 2 and for industrial applications (x 100 units)	107275

Lighting

Linear luminaire For fluorescent lamps

GRP

6401/562-8508-25-232 Art. No. 239563



Bracket for wall mounting with tube

Art. No.

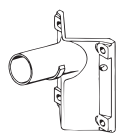

for side entry lamp; with tube, length 400 mm, Ø 42 mm

108947

Breather

Art. No.

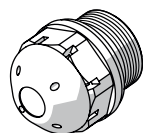

Thread: M25 x 1.5; 1 pc; for installation in lights; in moulded material; without counter nut

138573

Thread: M25 x 1.5; 20 pc; for installation in lights; in moulded material; without counter nut

138576

Ceiling and wall mounting bracket

Art. No.

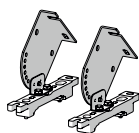

mounted on a mounting rail for a variable mounting distance; Material: stainless steel; Lamp can be swiveled in steps of 15°; 1 pair

222827

Contact element

Art. No.

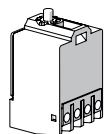

8080/1-3-L 2 NC contact element

132527

Cover

Art. No.

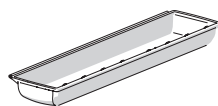

for luminaire size 6

222429

Fluorescent lamp

Art. No.

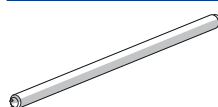

58 W, 5200 lm

108950

Mounting bracket

Art. No.

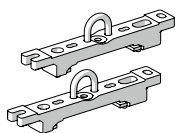

mounting clamp mounted on a mounting rail for a variable mounting distance; 1 pair

222456

Mounting rail

Art. No.

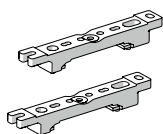

for a variable mounting distance; 1 pair

222826

Pipe clamp

Art. No.

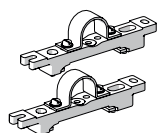

R 1 1/2"; with mounting rail for a variable mounting distance; Material: stainless steel; 1 pair

222459

R 1 1/4"; with mounting rail for a variable mounting distance; Material: stainless steel; 1 pair

222458

R 2"; with mounting rail for a variable mounting distance; Material: stainless steel; 1 pair

222460



Lighting

Linear luminaire For fluorescent lamps

GRP

6401/562-8508-25-232 Art. No. 239563

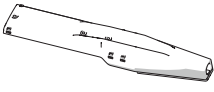

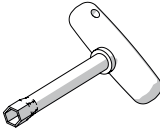
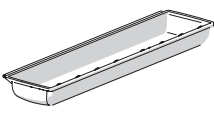
		Art. No.
Pole mounting sleeve		
	for the subsequent mounting on lights size 2 and size 4, completely with assembly parts	227512
Ring bolt		
	M8, direct mounting in insert nuts; 1 pair	115736
Socket key		
	M8 / wrench size 13; to open/close the central locking	222430
Cover		
	for luminaire size 6 (resistant to aromatic substances)	256536

We reserve the right to make alterations to the technical data, dimensions, weights, designs and products available without notice. The illustrations cannot be considered binding.