

For freight containers that comply with ISO 1161

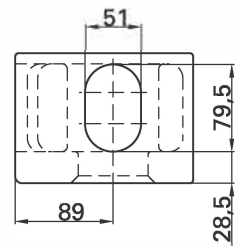
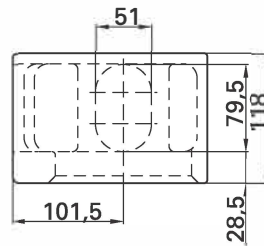
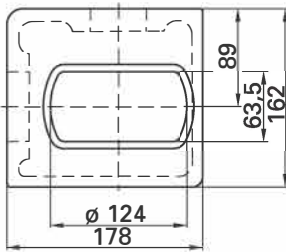
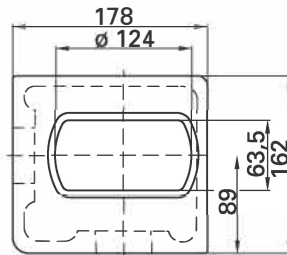
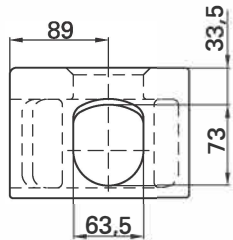
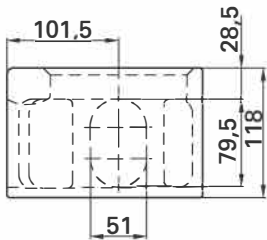
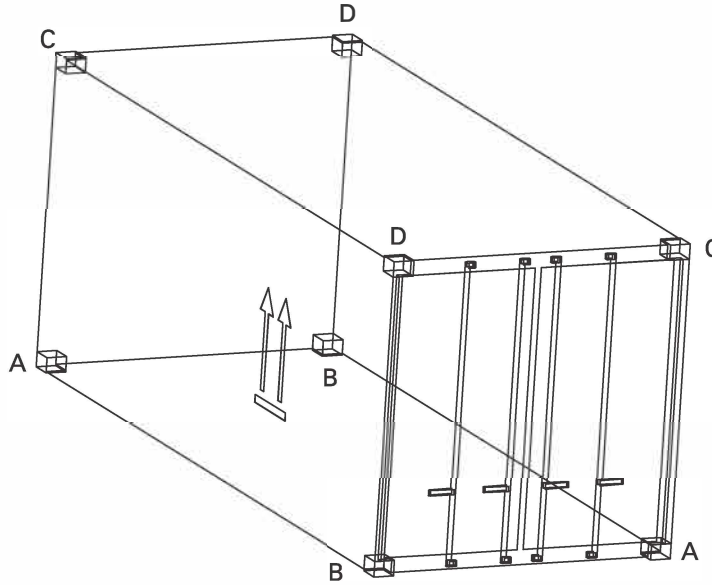

CC 297 TL

CC 299 BL

Use: Freight containers and similar bodies with acceptance test certificate comparable with 3.2 in accordance with EN 10204 (please specify requirement in the order).

Selection table / Available versions

Material	Standard	Item	Weight (kg)	Order No.	Drawing No.
Cast steel	ISO 1161	D	11.0	CC 297 TL	905.297.000
Cast steel	ISO 1161	C	11.0	CC 298 TR	905.298.000
Cast steel	ISO 1161	B	11.0	CC 299 BL	905.299.000
Cast steel	ISO 1161	A	11.0	CC 300 BR	905.300.000