

# MX-SERIES FLOW METERS

## DIGITAL FLOW METERS

The Digital Flow Meter range are the latest innovation from Macnaught. They feature billet construction\* offering optimal operational reliability and accuracy. Supplied with an individual Test Report, these meters are also marked with the actual K factor from calibration testing for an accuracy of +/- 0.5%. Their construction is modular allowing for simple in situ maintenance and system changes.

## EXPLODED DIAGRAM

MX-SERIES FLOW METERS

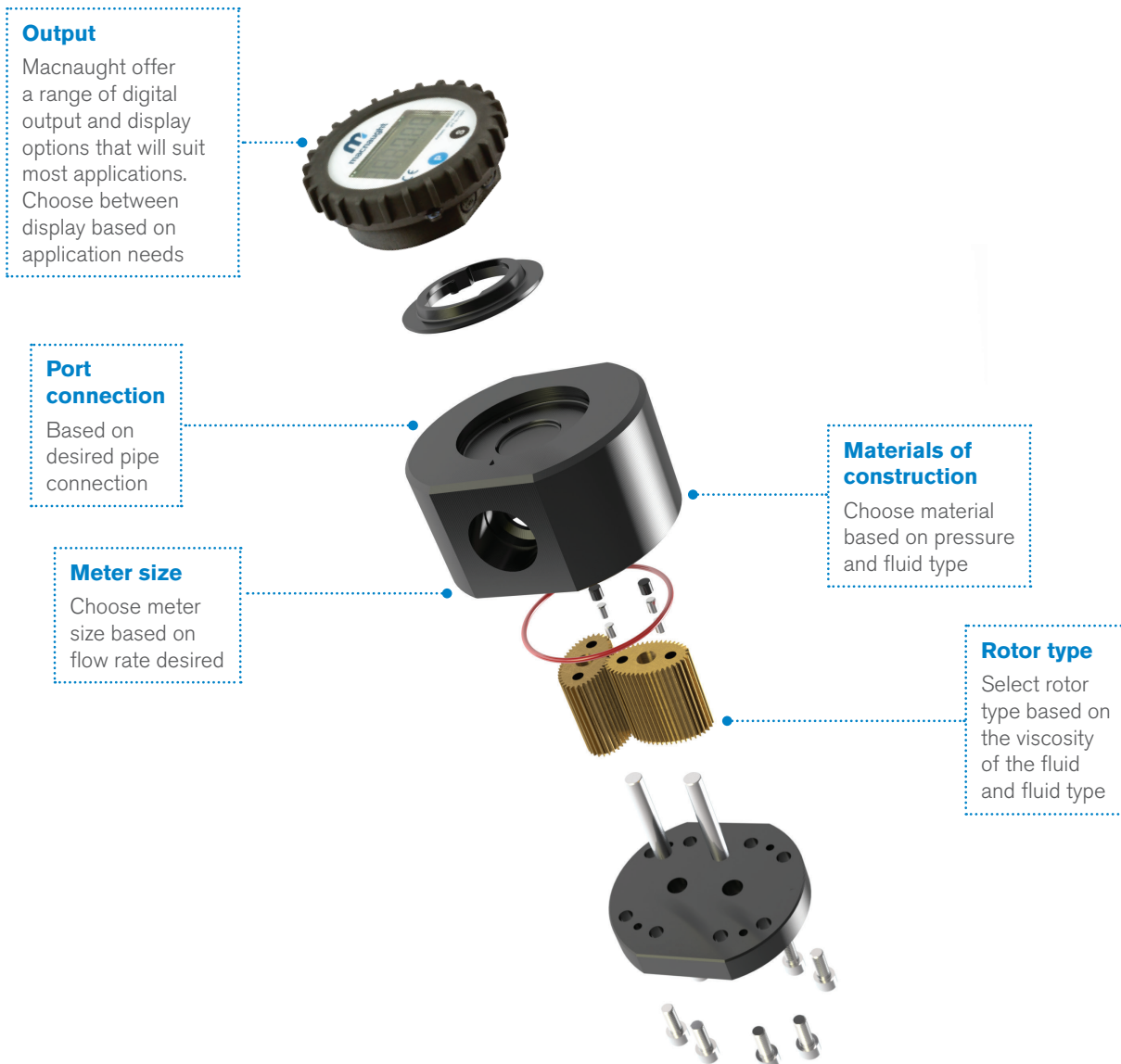

\*Billet construction across the MX meters up to 2"

**PRODUCT IDENTIFICATION SYSTEM**

# MX06P-1SE

**MX06**

**P**

**1**

**S**

**E**

MX PORT SIZE								
06	09	12	19	25	40	50	75	100
1/4"	1/4"	1/2"	3/4"	1"	1 1/2"	2"	3"	4"

MATERIALS OF CONSTRUCTION		
	CATEGORY (METER/ROTOR/SEAL)	MODELS
<b>F</b>	AL/PPS/FKM	MX06-50
	AL/AL/FKM	MX75-100
<b>P</b>	SS/PPS/FEP	MX06-50
<b>S</b>	AL/SS/FEP	MX06-25
	AL/AL/FEP	MX40-100

	PORT CONNECTION	MODEL
<b>1</b>	G	All Models
<b>2</b>	NPT	
<b>3</b>	ANSI 150	MX25-100
<b>4</b>	JIS 10K	
<b>5</b>	DIN PN16	

	ROTOR TYPE	MODELS
<b>S</b>	Standard	As per category
<b>T</b>	High Temp. Pulse	MX06P - MX50P
<b>V</b>	High Viscosity	S and P category

	OUTPUT TYPE	MODELS
<b>X</b>	No Output	All Models
<b>A</b>	Standard Pulse	All Models
<b>B</b>	Ex approved (Ex ia)	Consult Macnaught Technical regarding availability
<b>D</b>	PR (LCD 12mm display)	All Models
<b>E</b>	PRA (LCD 12mm display)	All Models
<b>F</b>	ER (LCD 17mm display)	All Models*
<b>G</b>	ERA (LCD 17mm display)	All Models*
<b>H</b>	ERB (LCD 17mm display)	All Models*
<b>N</b>	Ex Approved (Ex ia NAMUR)	Consult Macnaught Technical regarding availability
<b>T</b>	High Temperature	All Models
<b>I</b>	Reed/Reed	Consult Macnaught Technical regarding availability
<b>J</b>	Hall/Hall	
<b>K</b>	High Resolution (omnipolar)	

MX-SERIES FLOW METERS