



PUSH BUTTON SWITCH

KPB30**CLASSIFICATION****KPB-30 W M - R 1 1**

① ② ③ ④ ⑤

① PROTECTION	NONE	IP40
	W	IP65
② ACTUATOR	M	PUSH BUTTON, MOMENTARY
	AT	PUSH BUTTON, MAINTAINED
	EM	MUSHROOM HEADED PUSH BUTTON, MOMENTARY
	EA	MUSHROOM HEADED PUSH BUTTON, MAINTAINED
	ER	PUSH BUTTON, TURN TO RESET
	EP	PUSH BUTTON, PULL TO RESET
	③ COLOR	R
G		GREEN
Y		YELLOW
B		BLUE
W		WHITE
BK		BLACK
④ CONTACTS	NUMBER	NUMBER OF NO CONTACT
⑤ CONTACTS	NUMBER	NUMBER OF NC CONTACT

CONTROL COMPONENT



KPB30M
KPB30WM
KPB30AT
KPB30WAT



KPB30EM
KPB30WEM
KPB30EA
KPB30WEA



KPB30ER
KPB30WER



KPB30EP
KPB30WEP



KPB30MS, KPB30ML

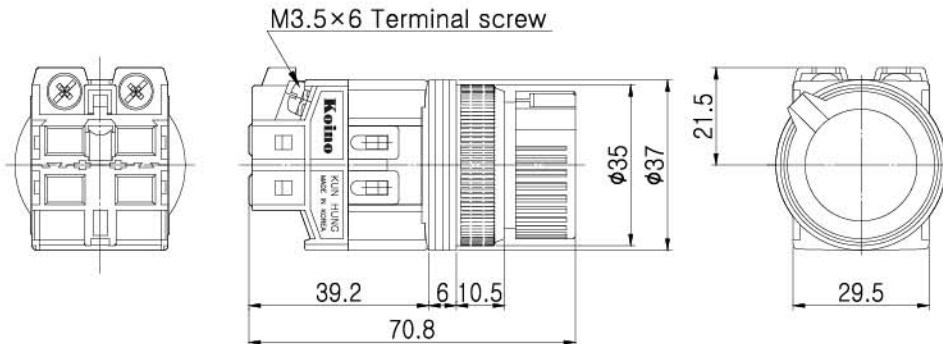

CONTROL COMPONENTS

SQUARE LIGHT

TOWER LIGHT

MICRO SWITCH

FOOT SWITCH

LIMIT SWITCH

POWER SWITCH

HOIST SWITCH

CAM SWITCH

BUZZER

PHOTO SENSOR

PROXIMITY SENSOR

FLOATLESS LEVEL SWITCH

TIMER & COUNTER

RELAY

SOCKETS

TERMINAL BLOCK

CONTROL BOX

PID TEMP. CONTROLLER



KPB30M KPB30WM

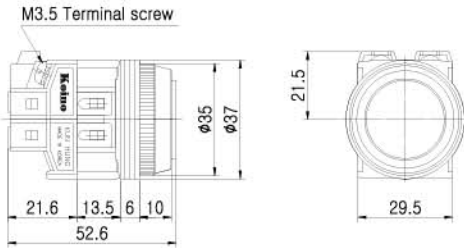

KPB30AT KPB30WAT

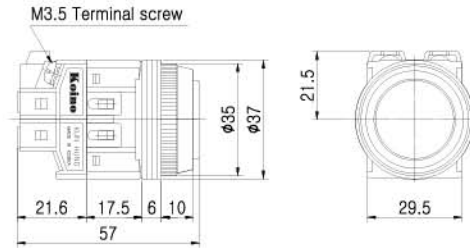

KPB30EM KPB30WEM

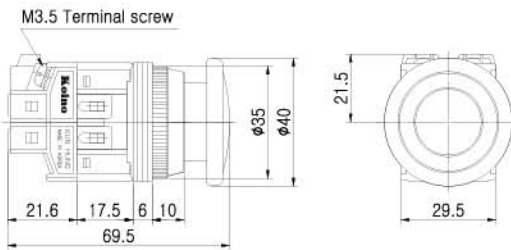

KPB30EA KPB30WEA

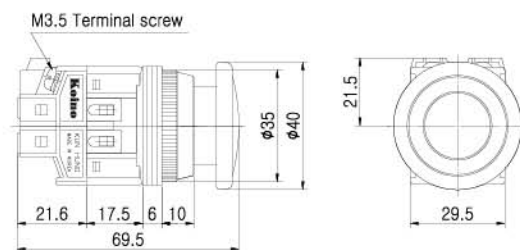

KPB30ER KPB30WER

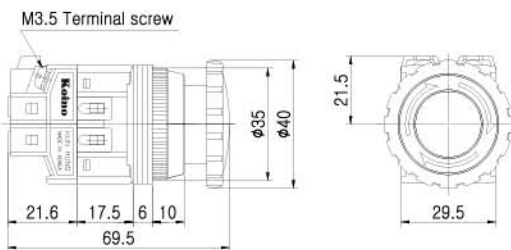

KPB30EP KPB30WEP

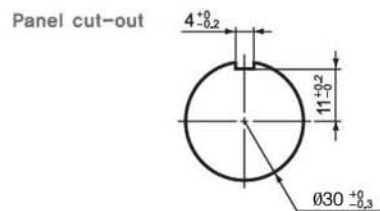
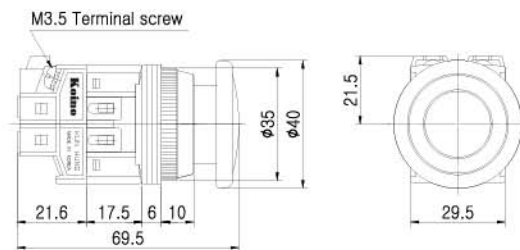



CONTROL COMPONENTS

SQUARE LIGHT

TOWER LIGHT

MICRO SWITCH

FOOT SWITCH

LIMIT SWITCH

POWER SWITCH

HOIST SWITCH

CAM SWITCH

BUZZER

PHOTO SENSOR

PROXIMITY SENSOR

FLOATLESS LEVEL SWITCH

TIMER & COUNTER

RELAY

SOCKETS

TERMINAL BLOCK

CONTROL BOX

PID TEMP. CONTROLLER

Technical Information

Switching System

The switching element of KPB30 is equipped with normally open contact and normally closed contact.

Material

Contact

Silver alloy + Copper

Housing

BODY: Nylon glass

CONTACT HOUSING: Nylon glass

Buttons

Acetal

Ring

ABS

Mechanical Characteristics

Mechanical Lifetime

1,000,000 Cycles of operation

Install

Tightening torque : Max. 0.8N · m

Electrical Characteristics

Standards

This product comply with “ Standards for low-voltage switching devices” EN IEC 60947-5-1

Contact Ratings

250VAC 6A (resistive load)

Insulation Resistance

Minimum 100MΩ (500VDC)

Contact Resistance

Maximum 30mΩ

Electrical Lifetime

100,000 cycles of operation



Electrical Characteristics—continues

Dielectric Strength

Between Live Parts: 1,500VAC(50/60Hz) for 1 minute
Between Live and Dead Parts: 1,500VAC(50/60Hz) for 1 minute

Environmental conditions

Operational Temperature

-25° C~+50° C

Operational Humidity

45~85%RH

Protection Degree

IP40 / IP65("W" type)

Shock Resistance

Approximately 50G(500m/s²)

Vibration Resistance

10~55Hz double amplitude 1.5mm (at X, Y and Z axis)

Approvals

Approbations

UL, CCC, KC

Declaration of Conformity

CE