



## PUSH BUTTON SWITCH

**KPB30****CLASSIFICATION****KPB-30 W M - R 1 1**

① ② ③ ④ ⑤

① PROTECTION	NONE	IP40
	W	IP65
② ACTUATOR	M	PUSH BUTTON, MOMENTARY
	AT	PUSH BUTTON, MAINTAINED
	EM	MUSHROOM HEADED PUSH BUTTON, MOMENTARY
	EA	MUSHROOM HEADED PUSH BUTTON, MAINTAINED
	ER	PUSH BUTTON, TURN TO RESET
	EP	PUSH BUTTON, PULL TO RESET
③ COLOR	R	RED
	G	GREEN
	Y	YELLOW
	B	BLUE
	W	WHITE
	BK	BLACK
④ CONTACTS	NUMBER	NUMBER OF NO CONTACT
⑤ CONTACTS	NUMBER	NUMBER OF NC CONTACT

CONTROL COMPONENT



KPB30M  
KPB30WM  
KPB30AT  
KPB30WAT



KPB30EM  
KPB30WEM  
KPB30EA  
KPB30WEA



KPB30ER  
KPB30WER



KPB30EP  
KPB30WEP



KPB30MS, KPB30ML

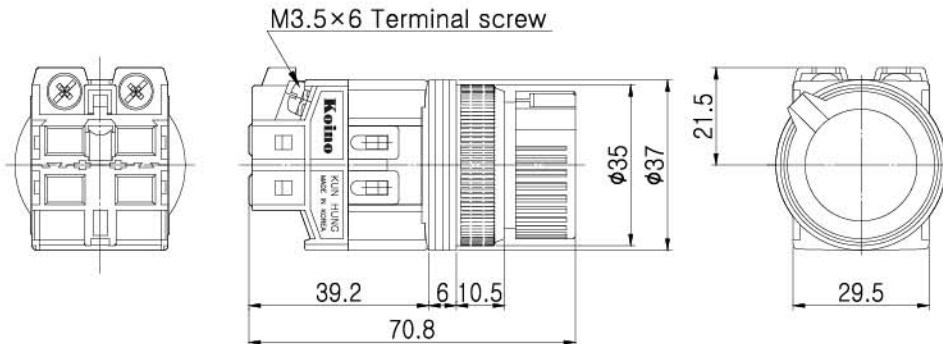

CONTROL COMPONENTS

SQUARE LIGHT

TOWER LIGHT

MICRO SWITCH

FOOT SWITCH

LIMIT SWITCH

POWER SWITCH

HOIST SWITCH

CAM SWITCH

BUZZER

PHOTO SENSOR

PROXIMITY SENSOR

FLOATLESS LEVEL SWITCH

TIMER & COUNTER

RELAY

SOCKETS

TERMINAL BLOCK

CONTROL BOX

PID TEMP. CONTROLLER



KPB30M KPB30WM

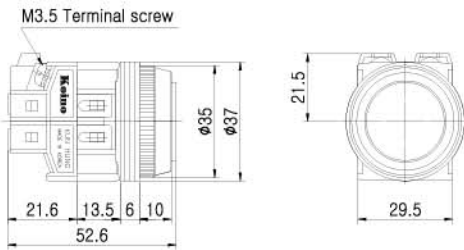

KPB30AT KPB30WAT

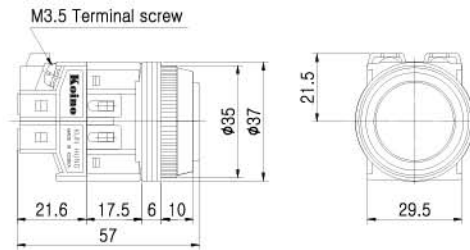

KPB30EM KPB30WEM

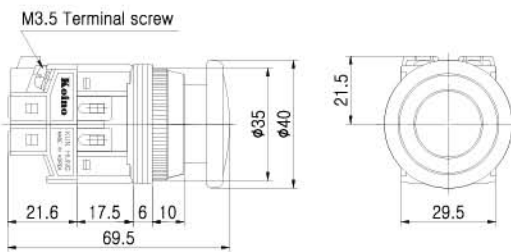

KPB30EA KPB30WEA

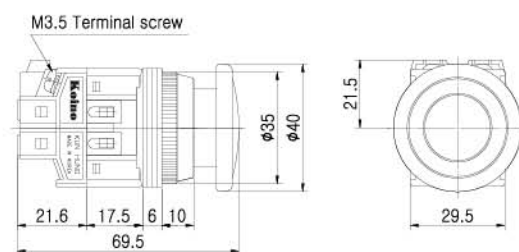

KPB30ER KPB30WER

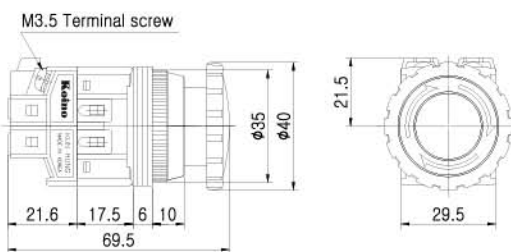

KPB30EP KPB30WEP

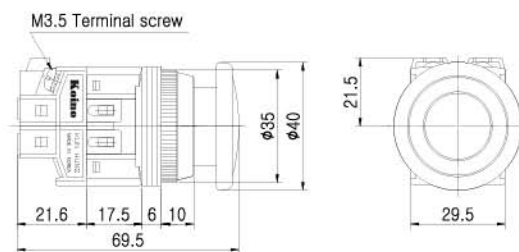

Panel cut-out

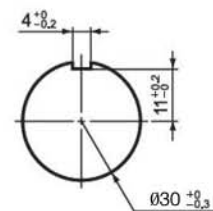



## CONTROL COMPONENTS

SQUARE LIGHT

TOWER LIGHT

MICRO SWITCH

FOOT SWITCH

LIMIT SWITCH

POWER SWITCH

HOIST SWITCH

CAM SWITCH

BUZZER

PHOTO SENSOR

PROXIMITY SENSOR

FLOATLESS LEVEL SWITCH

TIMER &amp; COUNTER

RELAY

SOCKETS

TERMINAL BLOCK

CONTROL BOX

PID TEMP. CONTROLLER

## Technical Information

### Switching System

The switching element of KPB30 is equipped with normally open contact and normally closed contact.

### Material

#### Contact

Silver alloy + Copper

#### Housing

BODY: Nylon glass

CONTACT HOUSING: Nylon glass

#### Buttons

Acetal

#### Ring

ABS

### Mechanical Characteristics

#### Mechanical Lifetime

1,000,000 Cycles of operation

#### Install

Tightening torque : Max. 0.8N · m

### Electrical Characteristics

#### Standards

This product comply with “ Standards for low-voltage switching devices” EN IEC 60947-5-1

#### Contact Ratings

250VAC 6A (resistive load)

#### Insulation Resistance

Minimum 100MΩ (500VDC)

#### Contact Resistance

Maximum 30mΩ

#### Electrical Lifetime

100,000 cycles of operation



**Electrical Characteristics—continues**

**Dielectric Strength**

Between Live Parts: 1,500VAC(50/60Hz) for 1 minute  
Between Live and Dead Parts: 1,500VAC(50/60Hz) for 1 minute

**Environmental conditions**

**Operational Temperature**

-25° C~+50° C

**Operational Humidity**

45~85%RH

**Protection Degree**

IP40 / IP65( "W" type)

**Shock Resistance**

Approximately 50G(500m/s<sup>2</sup>)

**Vibration Resistance**

10~55Hz double amplitude 1.5mm (at X, Y and Z axis)

**Approvals**

**Approbations**

UL, CCC, KC

**Declaration of Conformity**

CE